

Final Program



# JIM 2015

joint interventional meeting  
in partnership with 

**Leadership in Live Case Demonstration**

**February 12 - 14, 2015**  
**Rome, Italy**

**COURSE DIRECTORS**

Antonio Colombo, MD • Eberhard Grube, MD  
Martin B. Leon, MD • Carlo Di Mario, MD  
Jeffrey W. Moses, MD • Gregg W. Stone, MD

**SPECIAL BRS SESSION**

**on Wednesday February 11**

[www.jim-vascular.com](http://www.jim-vascular.com)

# Faculty Members

## Course Directors

Antonio COLOMBO, MD  
Eberhard GRUBE, MD  
Martin B. LEON, MD  
Carlo DI MARIO, MD  
Jeffrey W. MOSES, MD  
Gregg W. STONE, MD

## Associate Directors

Alexandre C. ABIZAID, MD  
Eulogio J. GARCIA, MD  
Marie Claude MORICE, MD  
Christoph NABER, MD  
Seung JUNG PARK, MD  
Jeffrey POPMA, MD  
Stephan WINDECKER, MD

## Live Satellite Transmissions

From **Milan**



From **Bonn**



From **Massy**



## Presented by

**ST. RAFFAELE SCIENTIFIC INSTITUTE**

Milan, Italy

**UNIVERSITY HOSPITAL BONN**

Bonn, Germany

**CARDIOVASCULAR INSTITUTE PARIS-SUD**

Massy, France

## Useful Addresses

### Organizing Secretariat

---

#### Victory Project Congressi

Via C. Poma, 2  
20129 Milan • Italy  
Phone +39 02 89 05 35 24  
Fax +39 02 20 13 95  
e-mail info@victoryproject.it

### Congress Venue

---

#### Ergife Palace Hotel

Via Aurelia, 619  
00165 Rome • Italy  
Phone +39 06 66 441  
www.ergifepalacehotel.com

[www.jim-vascular.com](http://www.jim-vascular.com)

( Program updated to  
February 3<sup>rd</sup> 2015 )

## Welcome

### *We are very pleased to welcome you in Rome again on February 12 - 14, 2015!*

The partnership with TCT/CRF is an infusion of new energy to JIM to better deliver a fruitful educational experience to the attendee.

**JIM is "The Live Case Meeting" and it will keep this unique characteristic.**

We will demonstrate what we mean for optimal implantation of a drug eluting stent and of bioresorbable scaffold in complex coronary lesions.

We believe that this strategy will further improve the safety and performance of these devices.

Live demonstrations will include treatment of adult valvular heart disease, structural heart disease. We will introduce new devices without losing close contact to the daily practice of the busy Interventionist.

The meeting maintains its format with "State of the Art" lectures given by experts in the field. Lunch and evening symposia fulfill this target. Symposia from different Cardiac Societies, including a PCR Symposium, will diversify the lectures and open the access to more contributions.

This year we have again live transmission on Saturday morning in order to maintain a well-balanced distribution of live cases throughout the entire meeting.

More emphasis and expansion are given to those sessions in which attendees can present and discuss cases.

Once again the Meeting will take place in Rome at Ergife Palace Hotel. It combines a comfortable accommodation solution with a large and efficient Congress Centre.

*Antonio Colombo, MD  
Eberhard Grube, MD*

# Faculty Members

## Invited Faculty

**ALEXANDRE C. ABIZAID, MD**  
Sao Paulo - Brazil

**STEPHAN ACHENBACH, MD**  
Erlangen - Germany

**EUSTACHIO AGRICOLA, MD**  
Milan - Italy

**JUNG-MIN AHN, MD**  
Seoul - Korea

**TAKASHI AKASAKA, MD**  
Wakayama - Japan

**ARIF AL NOORYANI, MD**  
Sharjah - United Arab Emirates

**YARON ALMAGOR, MD**  
Jerusalem - Israel

**DAVID ANTONIUCCI, MD**  
Florence - Italy

**GUILHERME ATTIZZANI, MD**  
Cleveland, OH - USA

**MARCO BARBANTI, MD**  
Catania - Italy

**ANTONIO BARTORELLI, MD**  
Milan - Italy

**ANDREAS BAUMBACH, MD**  
Bristol - UK

**FRANCESCO BEDOGNI, MD**  
Milan - Italy

**SERGIO BERTI, MD**  
Massa - Italy

**PETER BOEKSTEGERS, MD**  
Siegburg - Germany

**ALESSANDRO BORTONE, MD**  
Bari - Italy

**CARLO BRIGUORI, MD**  
Naples - Italy

**TODD BRINTON, MD**  
Stanford, CA - USA

**MAURICE BUCHBINDER, MD**  
La Jolla, CA - USA

**LUTZ BUELLESELD, MD**  
Bonn - Germany

**BERNARD CHEVALIER, MD**  
Massy - France

**ALAIDE CHIEFFO, MD**  
Milan - Italy

**NICOLA CORCIONE, MD**  
San Giuseppe Vesuviano - Italy

**ANIBAL DAMONTE, MD**  
Buenos Aires - Argentina

**GIAN BATTISTA DANZI, MD**  
Pietra Ligure - Italy

**MAURO DE BENEDICTIS, MD**  
Turin - Italy

**FEDERICO DE MARCO, MD**  
Milan - Italy

**PAOLO DENTI, MD**  
Milan - Italy

**CARLO DI MARIO, MD**  
London - UK

**DARIUSZ DUDEK, MD**  
Krakow - Poland

**DAVID ERLINGE, MD**  
Lund - Sweden

**THOMAS FELDERHOFF, MD**  
Siegburg - Germany

**TED FELDMAN, MD**  
Evanston, IL - USA

**LEO FINCI, MD**  
Geneva - Switzerland

**ROBERTO GARBO, MD**  
Turin - Italy

**EULOGIO GARCIA, MD**  
Madrid - Spain

**PHILIPPE GAROT, MD**  
Massy - France

**LAURA GATTO, MD**  
Rome - Italy

**ARTURO GIORDANO, MD**  
San Giuseppe Vesuviano - Italy

**OMER GOKTEKIN, MD**  
Istanbul - Turkey



# Faculty Members

## Invited Faculty

**STEVEN GOLDBERG, MD**  
Seattle, WA - USA

**JUAN GRANADA, MD**  
New York, NY - USA

**CARMELO GRASSO, MD**  
Catania - Italy

**GIULIO GUAGLIUMI, MD**  
Bergamo - Italy

**THORSTEN HANKE, MD**  
Lubeck - Germany

**DAVID HILDICK-SMITH, MD**  
Brighton - UK

**CIRO INDOLFI, MD**  
Catanzaro - Italy

**DIMITRIOS KARPALOTIS, MD**  
New York, NY - USA

**MARKUS KASEL, MD**  
Munich - Germany

**SASKO KEDEV, MD**  
Skopje - Macedonia

**TIM KINNAIRD, MD**  
Cardiff - UK

**SUSHEEL KODALI, MD**  
New York, NY - USA

**KARL HEINZ KUCK, MD**  
Hamburg - Germany

**ALESSIO LA MANNA, MD**  
Catania - Italy

**AZEEM LATIB, MD**  
Milan - Italy

**MICHAEL KANG-YIN LEE, MD**  
Hong Kong - China

**THIERRY LEFEVRE, MD**  
Massy - France

**PEDRO LEMOS, MD**  
Sao Paulo - Brazil

**MARTIN B. LEON, MD**  
New York, NY - USA

**FRANCESCO MAISANO, MD**  
Zurich - Switzerland

**JOSE' A. MANGIONE, MD**  
Sao Paolo - Brasil

**GANESH MANOHARAN, MD**  
Belfast - UK

**ALFREDO MARCHESE, MD**  
Bari - Italy

**ALBERTO MARGONATO, MD**  
Milan - Italy

**SEBASTIANO MARRA, MD**  
Turin - Italy

**ROXANA MEHRAN, MD**  
New York, NY - USA

**OSCAR MENDIZ, MD**  
Buenos Aires - Argentina

**GHADA MIKHAIL, MD**  
London - UK

**HELGE MÖLLMANN, MD**  
Bad Nauheim - Germany

**MARCO MOJOLI, MD**  
Padova - Italy

**MARIE CLAUDE MORICE, MD**  
Massy - France

**JEFFREY W. MOSES, MD**  
New York, NY - USA

**GIUSEPPE MUSUMECI, MD**  
Bergamo - Italy

**CHRISTOPH NABER, MD**  
Essen - Germany

**SUNAO NAKAMURA, MD**  
Tokyo - Japan

**GAKU NAKAZAWA, MD**  
Tokyo - Japan

**YOSHINOBU ONUMA, MD**  
Rotterdam - The Netherlands

**SEUNG-JUNG PARK, MD**  
Seoul - Korea

**ANNA SONIA PETRONIO, MD**  
Pisa - Italy

**AUGUSTO PICHARD, MD**  
Washington, DC - USA

## Invited Faculty

**JEFFREY POPMA, MD**

Boston, MA - USA

**FRANCESCO PRATI, MD**

Rome - Italy

**PATRIZIA PRESBITERO, MD**

Milan - Italy

**EVELYN REGAR, MD**

Rotterdam - The Netherlands

**BERNHARD REIMERS, MD**

Mirano - Italy

**HENRIQUE RIBEIRO, MD**

Sao Paulo - Brazil

**ALFREDO E. RODRIGUEZ, MD**

Buenos Aires - Argentina

**MANEL SABATE, MD**

Barcelona - Spain

**FRANCESCO SAIA, MD**

Bologna - Italy

**GENNARO SARDELLA, MD**

Rome - Italy

**JOACHIM SCHOEFER, MD**

Hamburg - Germany

**ANTONIO SERRA, MD**

Barcelona - Spain

**PATRICK W. SERRUYS, MD**

Rotterdam - The Netherlands

**GEORGE SIANOS, MD**

Thessaloniki - Greece

**HORST SIEVERT, MD**

Frankfurt - Germany

**MOHAMED AHMED SOBHY, MD**

Alexandria - Egypt

**AMERIGO STABILE, MD**

Palermo - Italy

**GREGG W. STONE, MD**

New York, NY - USA

**CORRADO TAMBURINO, MD**

Catania - Italy

**LUCA TESTA, MD**

Milan - Italy

**HOLGER THIELE, MD**

Lübeck - Germany

**JONATHAN TOBIS, MD**

Los Angeles, CA - USA

**ROBERT-JAN VAN GEUNS, MD**

Rotterdam - The Netherlands

**NICOLAS VAN MIEGHEM, MD**

Rotterdam - The Netherlands

**FERDINANDO VARBELLA, MD**

Rivoli - Italy

**FRANCESCO VERSACI, MD**

Rome - Italy

**CONSTANTIN VON ZUR MÜHLEN, MD**

Freiburg - Germany

**MARCO WAINSTEIN, MD**

Porto Alegre - Brazil

**RON WAKSMAN, MD**

Washington, DC - USA

**STEPHAN WINDECKER, MD**

Bern - Switzerland

**JOCHEN WÖRHLE, MD**

Ulm - Germany

**ALAN YEUNG, MD**

Stanford, CA - USA

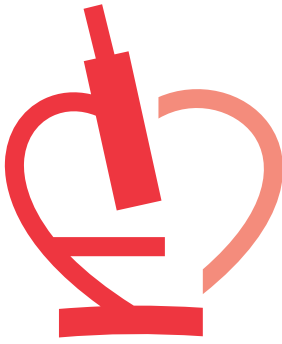

**f**ondazione  
**e**vidence  
**O**NLUS

- ♥ coordinates and develops cardiovascular research
- ♥ contributes to the formation of professional figures in this field
- ♥ promotes meetings, seminars and conferences in accordance with the aims of the foundation



**[www.fondevidence.org](http://www.fondevidence.org)**

Fondazione Evidence  
per Attività e Ricerche Cardiovascolari - Onlus

Sede Legale: Via Donizetti, 30 - 20122 Milano - Italy

Ph. +39 335 67 51 553

mail: [fondevidence@gmail.com](mailto:fondevidence@gmail.com)



## Patronages



Società Italiana  
di Cardiologia Invasiva

**SOCIETÀ ITALIANA DI CARDIOLOGIA INVASIVA**



**DEUTSCHE GESELLSCHAFT FÜR KARDIOLOGIE  
HERZ - UND KREISLAIFFORSCHUNG**



**BNK - BUNDESVERBAND NIEDERGELESENER  
KARDIOLOGEN**



**ARBEITSGEMEINSCHAFT LEITENDE  
KARDIOLOGISCHE KRANKENHAUSÄRZTE**

---

**FONDAZIONE GISE**

Scuola di Formazione Superiore di Interventistica Cardiovascolare

## Faculty Members

### Columbus Hospital Heart Center, Milan

#### FACULTY AND OPERATORS

Antonio Colombo, MD

Bruno Damascelli, MD

Filippo Figini, MD

Leo Finci, MD

Azeem Latib, MD

Gloria Melzi, MD

#### *Fellow and Research Associates*

Hiroyoshi Kawamoto, MD

Tadashi Miyazaki, MD

Neil Ruparelia, MD

#### *Cardiology and Intensive Coronary Care Sections*

Raffaella Alpago, MD

Giancarlo Biagi, MD

Alfredo Castelli, MD

Federica Della Rocca, MD

#### ANAESTHESIOLOGY DEPARTMENT

Romeo Arienta, MD

Enzo Caputo, MD

Massimo Croci, MD

Stefano Fattore, MD

Pierluigi Villa, MD

### University Hospital, Bonn

#### FACULTY AND OPERATORS

Eberhard Grube, MD

Christoph Hammerstingl, MD

Georg Nickenig, MD

Jan Malte Sinning, MD

Mariuca Vasa-Nicotera, MD

Nikos Werner, MD

#### CARDIOVASCULAR SURGERY DEPARTMENT

Armin Welz, MD

Fritz Mellert, MD

Wolfgang Schiller, MD

#### ANAESTHESIOLOGY DEPARTMENT

Andreas Hoeft, MD

Stefan Weber, MD



# Faculty Members

## St. Raffaele Scientific Institute, Milan

### FACULTY AND OPERATORS

Antonio Colombo, MD

Mauro Carlino, MD

Alfredo Castelli, MD

Alaide Chieffo, MD

Filippo Figini, MD

Azeem Latib, MD

Matteo Montorfano, MD

### *Fellows and Research Associates*

Nelson Ulises Bonilla Velasquez, MD

Rachele Contri, MD

André Cardona Lorette Do Carmo, MD

Francesco Giannini, MD

Hiroyoshi Kawamoto, MD

Antonio Mangieri, MD

Tadashi Miyazaki, MD

Rizkallah Rafik Ramsis, MD

Damiano Regazzoli, MD

Neil Ruparelia, MD

Stefano Stella, MD

### CARDIOTHORACIC DEPARTMENT

Ottavio Alfieri, MD - Section Director

Andrea Blasio, MD

Alessandro Castiglioni, MD

Micaela Cioni, MD

Michele De Bonis, MD

Paolo Denti, MD

David Ferrara, MD

Andrea Fumero, MD

Giuseppe Iaci, MD

Giovanni La Canna, MD

Elisabetta La Penna, MD

Stefano Moriggia, MD

Simona Nascimbene, MD

Maurizio Taramasso, MD

Alessandro Verzini, MD

### *Cardiology and Intensive*

### *Coronary Care Sections*

Alberto Margonato, MD - Section Director

Eustachio Agricola, MD

Carlo Ballarotto, MD

Alberto Cappelletti, MD

Andrea Conversano, MD

Cosmo Godino, MD

Valeria Magni, MD

Michele Opizzi, MD

Giuseppe Pizzetti, MD

### *Vascular Surgery Section*

Roberto Chiesa, MD - Section Director

Domenico Astore, MD

Renata Castellano, MD

Efrem Civilini, MD

Laura Dordoni, MD

Gloria Esposito, MD

Enrico Maria Marone, MD

Massimiliano Marrocco Trischitta, MD

Germano Melissano, MD

Yamume Tshomba, MD

### *Anaesthesiology and*

### *Cardiovascular Intensive Care Section*

Alberto Zangrillo, MD - Section Director

Elena Bignami, MD

Tiziana Bove, MD

Fabrizio Di Monaco, MD

Annalisa Franco, MD

Chiara Gerli, MD

Giulia Maj, MD

Federico Pappalardo, MD

Mara Scandroglio, MD

## Symposium - ROOM MICHELANGELO

### BIORESORBABLE VASCULAR SCAFFOLDS

#### A one-day case-based technique-oriented course

Sponsored by Cardiovascular Research Foundation

Course Directors: **Martin B. Leon, Patrick W. Serruys, Gregg W. Stone**

#### Session I. *The Big Picture*

Moderators: **Patrick W. Serruys and Gregg W. Stone**

Discussants: *All in this session*

- 7.55 - 8.00 Course introduction **Gregg W. Stone**
- 8.00 - 8.15 The pathobiology of bioresorbable vascular scaffolds: similarities to and differences from metallic DES **Juan Granada**
- 8.15 - 8.20 *Discussion and audience Q&A*
- 8.20 - 8.35 The vast BRS landscape: classification, meaningful differentiation, and future expectations **Alex Abizaid, Martin B. Leon**
- 8.35 - 8.40 *Discussion and audience Q&A*
- 8.40 - 8.55 Novel vascular responses of BRS (Absorb and beyond): insights from serial imaging and vasomotion studies **Patrick W. Serruys**
- 8.55 - 9.00 *Discussion and audience Q&A*
- 9.00 - 9.15 Emerging clinical evidence I: summarizing the registries **Corrado Tamburino**
- 9.15 - 9.20 *Discussion and audience Q&A*
- 9.20 - 9.35 Emerging evidence II: what have we learned from ABSORB II that we didn't already know? **Yoshinobu Onuma**
- 9.35 - 9.40 *Discussion and audience Q&A*
- 9.40 - 9.55 Emerging evidence III: limitations of metallic DES, and proving superiority of BRS **Gregg W. Stone**
- 9.55 - 10.00 *Discussion and audience Q&A*
- 10.00 - 10.15 *Break*

# Wednesday, February 11<sup>th</sup>, 2015

## Session II. Great BRS Cases I: Highlights and Lowlights

*Moderators:* **Antonio Colombo** and **Constantin von zur Mühlen**

*Discussants:* **Alexandre Abizaid**, **Antonio Bartorelli**, **Arif Al Nooryani**, **Martin B. Leon**, **Manel Sabate**, **Nicolas van Mieghem**, **Azeem Latib**

- 10.15 - 10.25 **My greatest short-term BRS success**  
*Case presenter:* **Antonio Colombo**
- 10.25 - 10.30 *Lead discussant:* **Antonio Bartorelli**
- 10.30 - 10.40 **My most regrettable BRS complication**  
*Case presenter:* **Corrado Tamburino**
- 10.40 - 10.45 *Lead discussant:* **Nicolas van Mieghem**
- 10.45 - 10.55 **My greatest long-term BRS success**  
*Case presenter:* **Anna Sonia Petronio**
- 10.55 - 11.00 *Lead discussant:* **Manel Sabate**
- 11.00 - 11.10 **My greatest short-term BRS success**  
*Case presenter:* **Carlo Di Mario**
- 11.10 - 11.15 *Lead discussant:* **Azeem Latib**
- 11.15 - 11.25 **My most regrettable BRS complication**  
*Case presenter:* **Antonio Colombo**
- 11.25 - 11.30 *Lead discussant:* **Arif Al Nooryani**
- 11.30 - 11.40 **My greatest long-term BRS success**  
*Case presenter:* **Corrado Tamburino**
- 11.40 - 11.45 *Lead discussant:* **Alexandre Abizaid**
- 11.45 - 11.55 **My longest BRS follow-up without drug (15 years)  
and with drug (8 years)**  
*Case presenter:* **Patrick W. Serruys**
- 11.55 - 12.00 *Lead discussant:* **Martin B. Leon**
- 12.00 - 13.00 *Lunch break*



## Session III. Technique optimization

**Moderators:** Martin B. Leon and Manel Sabate

**Discussants:** Carlo Di Mario, Arif Al Nooryani, Robert-Jan van Geuns, Giulio Guagliumi, Jeffrey W. Moses, Yoshinobu Onuma

- 13.00 - 13.15 Optimal BRS technique: my most important tips and tricks  
**Nicolas van Mieghem**
- 13.15 - 13.20 *Discussion and audience Q&A*
- 13.20 - 13.35 Imaging guidance of the BRS implant: nice to have or must have?  
OCT vs. IVUS? **Giulio Guagliumi**
- 13.35 - 13.40 *Discussion and audience Q&A*
- 13.40 - 13.55 The fundamental obligation of lesion preparation and post-BRS  
noncompliant balloon expansion (in calcified and non-calcified  
lesions) **Antonio Colombo**
- 13.55 - 14.00 *Discussion and audience Q&A*
- 14.00 - 14.10 Diffuse disease: scaffold overlap and other considerations  
**Stephan Achenbach**
- 14.10 - 14.15 *Discussion and audience Q&A*
- 14.15 - 14.30 Bifurcation treatment: differences from metallic DES and  
lesion-specific recommendations **Jochen Wöhrle**
- 14.30 - 14.35 *Discussion and audience Q&A*
- 14.35 - 14.50 Are BRS ideally suited for ACS lesions? Theory and practical  
recommendations **Dariusz Dudek**
- 14.50 - 14.55 *Discussion and audience Q&A*
- 14.55 - 15.10 Are BRS ideally Suited for CTOs? Theory and practical  
recommendations **Antonio Serra**
- 15.10 - 15.15 *Discussion and audience Q&A*
- 15.15 - 15.30 *Break*

# Wednesday, February 11<sup>th</sup>, 2015

## Session IV. Great BRS Cases II: Lesion-specific

*Moderators:* **Nicolas van Mieghem and Corrado Tamburino**

*Discussants:* **Carlo Di Mario, Dariusz Dudek, Stephan Achenbach, Jeffrey W. Moses, Anna Sonia Petronio, Gregg W. Stone, Ron Waksman, Constantin von zur Mühlen**

- 15.30 - 15.40 **Multivessel and diffuse disease case #1**  
*Case presenter:* **Alexandre Abizaid**
- 15.40 - 15.45 *Lead discussant:* **Constantin von zur Mühlen**
- 15.45 - 15.55 **Multivessel and diffuse disease case #2**  
*Case presenter:* **Jochen Wöhrle**
- 15.55 - 16.00 *Lead discussant:* **Stephan Achenbach**
- 16.00 - 16.10 **Complex bifurcation disease case #1 (non left main)**  
*Case presenter:* **Manel Sabate**
- 16.10 - 16.15 *Lead discussant:* **Anna Sonia Petronio**
- 16.15 - 16.25 **Complex bifurcation disease case #1 (left main)**  
*Case presenter:* **Azeem Latib**
- 16.25 - 16.30 *Lead discussant:* **Gregg W. Stone**
- 16.30 - 16.40 **A case with heavily calcified disease**  
*Case presenter:* **Nicolas van Mieghem**
- 16.40 - 16.45 *Lead discussant:* **Carlo Di Mario**
- 16.45 - 16.55 **A case with vessel and/or lesion tortuosity**  
*Case presenter:* **Antonio Bartorelli**
- 16.55 - 17.00 *Lead discussant:* **Ron Waksman**
- 17.00 - 17.10 **A wild CTO**  
*Case presenter:* **Antonio Serra**
- 17.10 - 17.15 *Lead discussant:* **Jeffrey W. Moses**
- 17.15 - 17.25 **A complex STEMI**  
*Case presenter:* **Robert-Jan van Geuns**
- 17.25 - 17.30 *Lead discussant:* **Dariusz Dudek**

## Session V. Closing Keynote Address

*Moderator:* **Gregg W. Stone**

- 17.30 - 17.45 **My Grand Vision for a bioresorbable future**  
**Patrick W. Serruys**
- 17.45 *Closing remarks and adjourn*

**MAIN HALL LEONARDO**

8.00 - 8.05

**Welcome and Opening Address**

Chairman: **Martin B. Leon**

Co-chairman: **Carlo Di Mario**

8.05 - 10.00



**LIVE CASES FROM BONN, GERMANY**

**University Hospital**

Commentators: **Federico De Marco, Ghada Mikhail, Joachim Schofer, Mohamed Ahmed Sobhy**

Operators: **Eberhard Grube, Georg Nickenig, Nikos Werner, Jan-Malte Sinning, Christoph Hammerstingl, Mariuca Vasa-Nicotera, Armin Welz, Fritz Mellert, Wolfgang Schiller**

Guest operators: **Maurice Buchbinder, Pedro Lemos, Marco Wainstein**

On-line factoids relevant to the cases presented:

**Filippo Figini** (Coordinator), **Francesco Giannini, Neil Ruparelia**

10.00 - 10.30

*Coffee break*

10.30 - 12.30



**LIVE CASES FROM MILAN, ITALY**

**St. Raffaele Hospital**

Commentators: **David Antonucci, Carlo Briguori, Lutz Buellesfeld, Oscar Mendiz, Alan Yeung**

Operators: **Antonio Colombo, Mauro Carlino, Alaide Chieffo, Azeem Latib, Matteo Montorfano**

Guest operator: **Georgios Sianos**

On-line factoids relevant to the cases presented:

**Filippo Figini** (Coordinator), **Francesco Giannini, Neil Ruparelia**

12.45 - 14.15

**Working Lunch** .....

12.45 - 14.15

**Lunch Symposium - ROOM MICHELANGELO**

**TAVI**

*Chairmen:* **Alexandre Abizaid, Joachim Schofer**

- 12.45 Confidence delivered: the New Corevalve Evolut R  
**Ganesh Manoharan**
- 12.58 The Lotus Valve: how a second generation valve improves outcomes  
**David Hildick-Smith**
- 13.11 ACURATE TAVI - From proof of concept to CE mark  
**Alexandre Abizaid**
- 13.24 Optimization of TAVI With SAPIEN 3 **Marco Barbanti**
- 13.37 Direct Flow Medical: innovation focused on patient outcomes  
**Horst Sievert**
- 13.50 Portico™ precise placement leads to optimal patient outcomes:  
St Jude Medical Programme Milestones **Helge Mollmann**
- 14.03 *Questions & Answers*

12.45 - 14.15

**Lunch Symposium - ROOM GIOTTO**

**DES**

*Chairmen:* **Augusto Pichard, Patrick W. Serruys**

- 12.45 COMBO dual therapy stent – 3 years review **Corrado Tamburino**
- 13.00 Complex coronary lesions and patients: from absorbable polymer  
to polymer-free technology **Luca Testa**
- 13.15 The Ultimaster DES: from design to guidelines **Alessio La Manna**
- 13.30 The Synergy Stent: optimal healing in complex patients  
**Sasko Kedev**
- 13.45 BioFreedom from concept to real world: bleeding risk and DAPT -  
Insights from the ongoing LEADERS Free trial **Carlo Briguori**
- 14.00 *Questions & Answers*

**Lunch Symposium - ROOM TIZIANO**

**WILL THESE TRIALS CHANGE MY PRACTICE?**

**PRAMI and CVLPRIT revisited: do we really need to treat all lesions straight away in patients presenting with a STEMI?**

*PCR sponsored session*

*Chairmen: **Andreas Baumbach, Marie Claude Morice***

- 12.45 Introduction **Andreas Baumbach**
- 12.50 A STEMI case with significant bystander disease  
**Christoph Naber**
- 12.55 *Discussion: Current practice*
- 13.05 What was known before PRAMi and CVLPRIT?  
**Corrado Tamburino**
- 13.20 The data: PRAMi and CVLPRIT revisited **Andreas Baumbach**
- 13.35 Trial interpretation: answers and open questions  
**Marie Claude Morice**
- 13.50 *Discussion: should we change our practice?*
- 14.05 Case conclusion **Christoph Naber**
- 14.10 Closing remarks **Marie Claude Morice**



**MAIN HALL LEONARDO**

Chairman: **Gregg W. Stone**  
Co-chairman: **Jeffrey J. Popma**

14.30 - 16.30



**LIVE CASES FROM MILAN, ITALY**  
**St. Raffaele Hospital**

*Commentators:* **Marco Barbanti, Omer Goktekin, Susheel Kodali, Sunao Nakamura, Gennaro Sardella**

*Operators:* **Antonio Colombo, Mauro Carlino, Alaide Chieffo, Azeem Latib, Matteo Montorfano**

*On-line factoids relevant to the cases presented:*  
**Filippo Figini (Coordinator), Francesco Giannini, Neil Ruparelia**

16.30 - 17.00

*Coffee break*

17.00 - 18.30



**LIVE CASES FROM BONN, GERMANY**  
**University Hospital**

*Commentators:* **Carlo Briguori, Ted Feldman, Karl Heinz Kuck, Horst Sievert, Ron Waksman**

*Operators:* **Eberhard Grube, Georg Nickenig, Nikos Werner, Jan-Malte Sinning, Christoph Hammerstingl, Mariuca Vasa-Nicotera, Armin Welz, Fritz Mellert, Wolfgang Schiller**

*Guest operators:* **Maurice Buchbinder, Pedro Lemos, Marco Wainstein**

*On-line factoids relevant to the cases presented:*  
**Filippo Figini (Coordinator), Francesco Giannini, Neil Ruparelia**

18.45 - 20.30

**Evening Symposia** .....

**Evening Symposium - ROOM MICHELANGELO**

**HIGHLIGHTS FROM TCT 2014 AND CURRENT CONTROVERSIES**

*Chairmen:* **Martin B. Leon,**  
**Roxana Mehran, Jeffrey W. Moses,**  
**Gregg W. Stone**



**Session I. PCI Pharmacotherapy Dilemmas**

- 18.45 - 18.50 Case Presentation **Roxana Mehran**  
18.50 - 19.05 Thoughtful commentary: The DAPT controversy after DAPT  
**Gregg W. Stone**  
19.05 - 19.20 Animated discussion  
*Moderator:* **Gregg W. Stone**  
*Discussants:* **Jeffrey W. Moses, Stephan Windecker**

**Session II. TAVI in 2015: A "Mainstream" Treatment?**

- 19.20 - 19.25 Case Presentation **Roxana Mehran**  
19.25 - 19.40 Thoughtful commentary: The argument for TAVR in (almost) everyone  
**Martin B. Leon**  
19.40 - 19.55 Animated discussion  
*Moderator:* **Martin B. Leon**  
  
*Discussants:* **Susheel Kodali, Stephan Windecker**

**Session III. Bioresorbable Scaffolds: Iterative Refinement or Revolution**

- 19.55 - 20.00 Case Presentation **Roxana Mehran**  
20.00 - 20.15 Thoughtful commentary: Will BRS be the dominant DES platform in the Future? **Patrick W. Serruys**  
20.15 - 20.30 Animated discussion  
*Moderator:* **Alexandre Abizaid**  
*Discussants:* **Alexandre Abizaid, Marie-Claude Morice, Gregg W. Stone**

18.45 - 20.30

**Evening Symposium - ROOM GIOTTO**

**OUT OF TROUBLE. A LIVE IN THE BOX SESSION**

CENTRO PER LA LOTTA CONTRO L'INFARTO -  
FONDAZIONE ONLUS sponsored session



Chairmen: **Francesco Prati, Francesco Versaci**

18.45 *Lecture* Avoid troubles: use IC imaging modalities to fine tune coronary interventions **Augusto Pichard**

*Five clinical cases. Thank goodness I had:*

19.00 OCT during complex angioplasty **Francesco Prati**

19.15 Local drug delivery of abciximab during primary angioplasty **Laura Gatto**

19.30 NIRS to avoid plaque embolization **Alessandro Bortone**

19.45 Many cases on my shoulders with TAVI **Corrado Tamburino**

20.00 Many cases on my shoulders with carotid angioplasty  
**Bernhard Reimers**

20.15 Just good luck **Joachim Schofer**

*A cocktail will be served during the Symposium*

18.45 - 20.30

**Evening Symposium - ROOM TIZIANO**

**THE HEART TEAM APPROACH IN COMPLEX CASES  
SURGERY, INTERVENTION OR CONSERVATIVE APPROACH?**

INTERVENTIONAL WORKING GROUP (AGIK) of the German Society  
of Cardiology (DGK) sponsored session

Chairmen: **Peter Boekstegers, Thomas Felderhoff,  
Thorsten Hanke, Holger Thiele**

18.45 *Opening remarks* **Holger Thiele**

18.50 - 19.15 *Case 1 presentation*  
*High-grade aortic valve stenosis and high grade mitral regurgitation  
in an octogenarian*

*Presenter:* **Helge Möllmann**

- How would I treat? **Thomas Felderhoff**
- How did I treat? **Helge Möllmann**

*Panel discussion*

19.15 - 19.40 *Case 2 presentation*  
*Coronary 2-3 artery disease with left ventricular ejection fraction < 35%  
plus high-grade mitral regurgitation*

*Presenter:* **Thorsten Hanke**

- How would I treat? **Holger Thiele**
- How did I treat? **Thorsten Hanke**

*Panel discussion*

19.40 - 20.05 *Case 3 presentation*

*Coronary 2-3 artery disease with previous CABG, high grade mitral regurgitation with concomitant tricuspid regurgitation grade II-III*

*Presenter: Peter Boekstegers*

- How would I treat? **Thomas Felderhoff**
- How did I treat? **Peter Boekstegers**

*Panel discussion*

20.05 - 20.30 *Case 4 presentation*

*Aortic stenosis with intermediate surgical risk*

*Presenter: Christoph Naber*

- How would I treat? **Thorsten Hanke**
- How did I treat? **Christoph Naber**

*Panel discussion*

*Closing remarks Peter Boekstegers*

*A cocktail will be served during the Symposium*

18.45 - 20.30

## **Evening Symposium - ROOM I**

### **SUCCESES, COMPLICATIONS AND CHALLENGING INDICATIONS**

*Chairman: Gennaro Sardella*

*Panel: Eustachio Agricola, Antonio Bartorelli, Francesco Bedogni, Paolo Denti, Arturo Giordano, Carmelo Grasso, Ciro Indolfi, Antonio Serra*

18.45 *Case presentation* **Francesco Bedogni**  
*Discussion: Panel*

19.00 *Case presentation* **Ciro Indolfi**  
*Discussion: Panel*

19.15 *Case presentation* **Arturo Giordano**  
*Discussion: Panel*

19.30 *Case presentation* **Carmelo Grasso**  
*Discussion: Panel*

19.45 *Case presentation* **Antonio Bartorelli**  
*Discussion: Panel*

20.00 *Case presentation* **Paolo Denti**  
*Discussion: Panel*

20.15 *Case presentation* **Antonio Serra**  
*Discussion: Panel*

*Conclusion Gennaro Sardella*

*A cocktail will be served during the Symposium*

## MAIN HALL LEONARDO

Chairman: **Martin B. Leon**

Co-chairman: **Stephan Windecker**

8.00 - 10.00



### LIVE CASES FROM BONN, GERMANY University Hospital

*Commentators:* **Federico De Marco, Eulogio Garcia, Omer Goktekin, Steven Goldberg, Bernhard Reimers**

*Operators:* **Eberhard Grube, Georg Nickenig, Nikos Werner, Jan-Malte Sinning, Christoph Hammerstingl, Mariuca Vasa-Nicotera, Armin Welz, Fritz Mellert, Wolfgang Schiller**

*Guest operators:* **Maurice Buchbinder, Marco Wainstein**

*On-line factoids relevant to the cases presented:*

**Alaide Chieffo (Coordinator), Francesco Giannini, Neil Ruparelia**

10.00 - 10.30

*Coffee break*

10.30 - 12.30



### LIVE CASES FROM MILAN, ITALY St. Raffaele Hospital

*Commentators:* **Seung Jung Park, Augusto Pichard, Mohamed Ahmed Sobhy, Jonathan Tobis**

*Operators:* **Antonio Colombo, Mauro Carlino, Filippo Figini, Matteo Montorfano**

*On-line factoids relevant to the cases presented:*

**Alaide Chieffo (Coordinator), Francesco Giannini, Neil Ruparelia**

12.45 - 14.15

**Working Lunch** .....



12.45 - 14.15

## Lunch Symposium - ROOM MICHELANGELO

### DCB AND DES

Chairmen: **Corrado Tamburino, Ron Waksman**

- 12.45 Innovative DES technologies from Meril **Mauro De Benedictis**
- 13.00 How innovative stent designs can optimise DES outcomes  
**Patrick W. Serruys**
- 13.15 Can Imaging differentiate dual therapy stent vs mono therapy DES?  
**Tim Kinnaird**
- 13.30 Second vs First generation DES in multiple vessel and unprotected left main: Insights from the multicenter, prospective and controlled ERACI IV study **Alfredo E. Rodriguez**
- 13.45 Resolute Onyx™: Advanced Workhorse DES powered by Core Wire Technology **Eulogio Garcia**
- 14.00 *Questions & Answers*

12.45 - 14.15

## Lunch Symposium - ROOM GIOTTO

### NEW PCI TECHNOLOGY (Imaging and Physiology)

Chairmen: **Jeffrey J. Popma, Alan Yeung**

- 12.45 The CGuard™ MicroNet covered stent - A new unique approach to carotid artery stenting **Yaron Almagor**
- 12.58 The use of Angiosculpt in complex lesions **Azeem Latib**
- 13.11 Physiology and imaging in ACS patients: the value of rapid exchange FFR and HD-IVUS **Evelyn Regar**
- 13.24 Lithoplasty: A New Approach to Treatment of Calcified Vascular Lesions  
**Todd Brinton**
- 13.37 Hemodynamic support during high risk interventional procedures: a call to action! **Jeffrey J. Popma**
- 13.50 Overview of the DESolve scaffold program: design, engineering and clinical insights **Alaide Chieffo**
- 14.03 *Questions & Answers*

12.45 - 14.15

## Lunch Symposium - ROOM TIZIANO

### MITRAL AND TRICUSPID VALVE INTERVENTIONS

Chairmen: **Ted Feldman, Joachim Schofer**

- 12.45 TITAN II: Long-term follow-up of third multi-center clinical study of Carillon™ mitral contour system **Steven Goldberg**
- 12.58 Percutaneous mitral and tricuspid annuloplasty with the Mitralign system **Alexandre Abizaid**
- 13.11 Transcatheter annuloplasty with the Cardioband. Surgical efficacy delivered with safety **Karl Heinz Kuck**
- 13.24 The Forgotten Valve under the spotlight: innovative solution to treat functional tricuspid regurgitation **Azeem Latib**
- 13.37 MitraClip: moving forward to contemporary indications  
**Francesco Maisano**
- 13.50 Amplatzer™ Amulet™: second generation device for LAAO **Sergio Berti**
- 14.03 *Questions & Answers*

**Don't miss...**

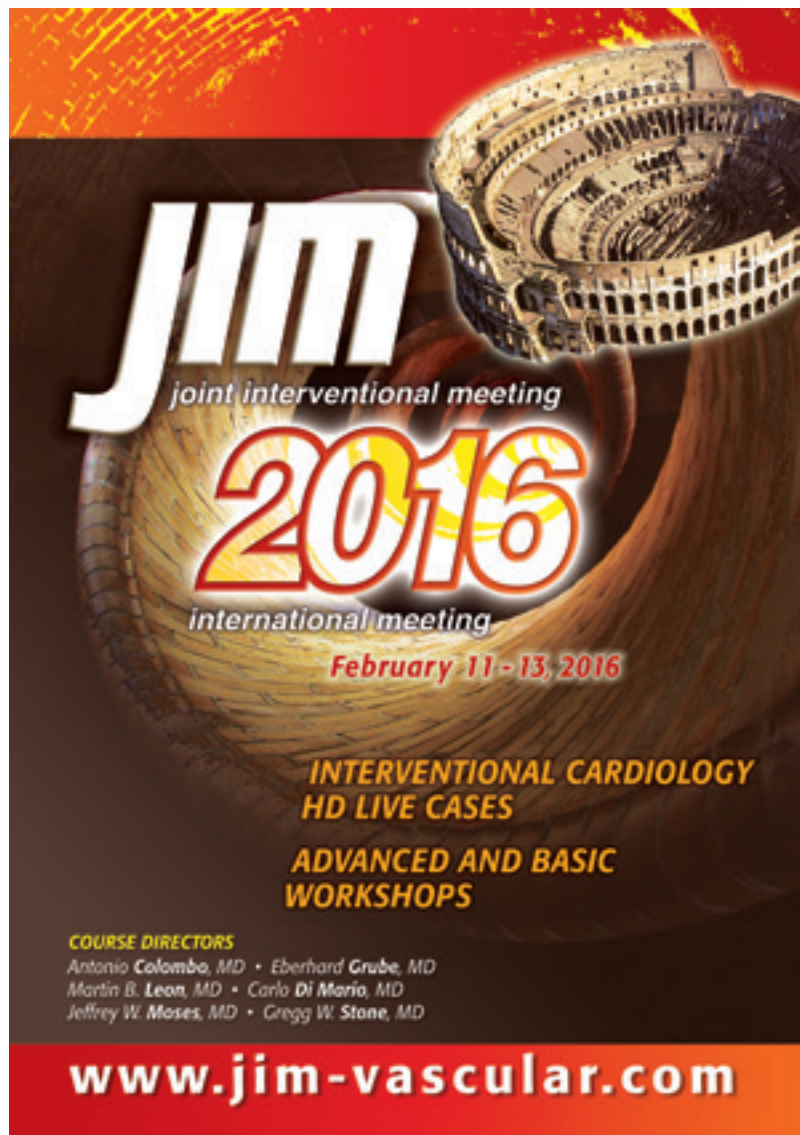

**JIM**  
joint interventional meeting

**2016**  
international meeting

February 11 - 13, 2016

**INTERVENTIONAL CARDIOLOGY  
HD LIVE CASES**

**ADVANCED AND BASIC  
WORKSHOPS**

**COURSE DIRECTORS**  
Antonio Colombo, MD • Eberhard Grube, MD  
Martin B. Leon, MD • Carlo Di Mario, MD  
Jeffrey W. Moses, MD • Gregg W. Stone, MD

**[www.jim-vascular.com](http://www.jim-vascular.com)**

## **MAIN HALL LEONARDO**

Chairman: **Antonio Colombo**  
Co-chairman: **Jeffrey W. Moses**

14.30 - 16.00



### **LIVE CASES FROM BONN, GERMANY** **University Hospital**

*Commentators:* **Yaron Almagor, Francesco Maisano, Patrizia Presbitero, Horst Sievert, Alan Yeung**

*Operators:* **Eberhard Grube, Georg Nickenig, Nikos Werner, Jan-Malte Sinning, Christoph Hammerstingl, Mariuca Vasa-Nicotera, Armin Welz, Fritz Mellert, Wolfgang Schiller**

*Guest operators:* **Maurice Buchbinder, Marco Wainstein**

*On-line factoids relevant to the cases presented:*  
**Alaide Chieffo (Coordinator), Francesco Giannini, Neil Ruparelia**

16.00 - 16.30

*Coffee break*

16.30 - 18.00



### **LIVE CASES FROM MILAN, ITALY** **St. Raffaele Hospital**

*Commentators:* **Roberto Garbo, Sebastiano Marra, Roxana Mehran, Holger Thiele**

*Operators:* **Mauro Carlino, Filippo Figini**

*Guest operators:* **Dimitrios Karpaliotis, Sunao Nakamura**

*On-line factoids relevant to the cases presented:*  
**Alaide Chieffo (Coordinator), Francesco Giannini, Neil Ruparelia**

18.15 - 20.30

**Evening Symposia** .....

18.15 - 20.30

## Evening Symposium - ROOM MICHELANGELO

### INTERVENTIONAL CHALLENGES IN CORONARY AND STRUCTURAL HEART DISEASE

*GISE sponsored session*

*Chairmen: Sergio Berti, Gennaro Sardella*

18.15- 18.45 *Clinical case 1*

*Anterograde or retrograde approach during CTO PCI* **Alessio La Manna**

- How would I treat? **Ferdinando Varbella**
- How would I treat? **Roberto Garbo**

*Conclusion* **Alessio La Manna**

18.45- 19.15 *Clinical case 2*

*Impact of a fast and effective platelet blockade in primary PCI*

**Giuseppe Musumeci**

- How would I treat? **Alfredo Marchese**
- How would I treat? **Gian Battista Danzi**

*Conclusion* **Giuseppe Musumeci**

19.15- 19.25 *Beneficial effects of Ivabradine on residual ischemia after PCI: only heart rate reduction?* **Alberto Margonato**

19.30- 20.00 *Clinical case 3*

*A hole in the argument (management of mitral perivalvular leak)*

**Marco Mojoli**

- How would I treat? **Francesco Bedogni**
- How would I treat? **Amerigo Stabile**

*Conclusion* **Marco Mojoli**

20.00- 20.30 *Clinical case 4*

*TAVI: a new device, new surprises* **Nicola Corcione**

- How would I treat? **Francesco Saia**
- How would I treat? **Federico De Marco**

*Conclusion* **Nicola Corcione**

18.15 - 20.30

## Evening Symposium - ROOM GIOTTO

### IMAGING AND PHYSIOLOGY FOR CORONARY INTERVENTION

*ASIA PACIFIC sponsored session*

*Chairmen: Takashi Akasaka, Michael Kang-Yin Lee, Marie Claude Morice, Seung-Jung Park*

*Discussants: Jung-Min Ahn, Alaide Chieffo, Gaku Nakazawa, Augusto Pichard*



## Friday, February 13<sup>th</sup>, 2015

18.15 Introduction **Seung-Jung Park**

### *Practical Use of IVUS and FFR*

18.20 Integrated use of FFR and IVUS for Left Main Disease **Augusto Pichard**

18.35 Integrated use of FFR and IVUS for Non-Left Main Disease (Long, Tandem and Bifurcation) **Jung-Min Ahn**

18.50 Can IVUS MLA predict functional significance of stenosis?  
**Seung-Jung Park**

19.05 Case-based role of sequential OCT for assessment of reendothelialisation of DES **Marie Claude Morice**

### *Define Vulnerable Plaque*

19.20 Correlation between pathology and imaging **Gaku Nakazawa**

19.35 Vulnerable plaque detection: between biological and morphological (OCT) approaches **Takashi Akasaka**

19.50 To treat or not to treat: functionally insignificant vulnerable plaque  
**Gregg W. Stone**

20.05 Can we prevent DEFER lesion event? PREVENT Trial - design and rationale **Seung-Jung Park**

20.20 Conclusions **Marie Claude Morice**

*A cocktail will be served during the Symposium*

18.15 - 20.30

## **Evening Symposium - ROOM TIZIANO**

### **FRONTIERS OF STRUCTURAL HEART INTERVENTION**

*SOUTH AMERICA sponsored session*

*Chairmen:* **Alexandre Abizaid, Pedro Lemos**

*Discussants:* **José A. Mangione, Roxana Mehran, Horst Sievert**

18.15 Is it possible to choose the best TAVI prosthesis for an individual case?  
**José A. Mangione**

18.35 Improving clinical success in TAVI: it is all about the details  
**Oscar Mendiz**

18.55 Tough calls in antithrombotic therapy after TAVI: the case of atrial fibrillation, associated coronary disease, previous stroke, thrombocytopenia and others **Henrique Ribeiro**

19.15 Getting around with the learning phase of edge-to-edge mitral repair: tips and tricks for new centers in MitraClip procedure  
**Guilherme Attizzani**

19.35 When is closure of left atrial appendage a must? **Anibal Damonte**

19.55 *Questions & Answers*

*A cocktail will be served during the Symposium*

# Saturday, February 14<sup>th</sup>, 2015

7.30 - 8.30

## Morning Symposium - ROOM GIOTTO

### ANTITHROMBOTIC AND ANTIPLATELET DECISIONS IN STEMI

CARDIOVASCULAR RESEARCH FOUNDATION sponsored session

Chairmen: **Gregg W. Stone, Roxana Mehran**

Discussants: **David Erlinge, Marie Claude Morice, Ron Waksman**

- 7.30 Antithrombin alternatives during primary PCI in STEMI **Gregg W. Stone**  
7.45 *Featured Lecture* Predictors of stent thrombosis after primary PCI in the real-world: New insights from the SCAAR registry **David Erlinge**  
8.00 ADP antagonists during primary PCI in STEMI **Roxana Mehran**  
8.15 *Roundtable discussion with audience Q&A*

## MAIN HALL LEONARDO

Chairmen of the day: **Antonio Colombo, Eberhard Grube**

Co-chairman: **Eulogio Garcia**

8.30 - 10.00



### LIVE CASES FROM MASSY, FRANCE

#### Cardiovascular Institute Paris-Sud

Commentators: **David Antoniucci, Sebastiano Marra, Marie Claude Morice, Francesco Prati, Jeffrey W. Moses**

Operators: **Bernard Chevalier, Philippe Garot, Thierry Lefevre**

On-line factoids relevant to the cases presented:

**Azeem Latib (Coordinator), Francesco Giannini, Neil Ruparelia**

10.00 - 11.30

### CASES PRESENTATION AND DEBATE

Chairmen: **Antonio Colombo, Eberhard Grube, Martin B. Leon**

**Marc Brezins**

*Nahariyya - Israel*

**Francesca Del Furia**

*San Donato Milanese, MI - Italy*

**Farhat Fouladvand**

*Erba, CO - Italy*

**Ioannis Iakovou**

*Athens - Greece*

**Francesco Moscato**

*Benevento - Italy*

**Salvatore Saccà**

*Mirano, VE - Italy*

**Kim Tae-Hoon**

*Bucheon - Republic of Korea*

**Riccardo Turri**

*Mirano, VE - Italy*

**Saturday, February 14<sup>th</sup>, 2015**

11.30 - 12.30



**LIVE CASES FROM MASSY, FRANCE**  
**Cardiovascular Institute Paris-Sud**

*Commentators:* **Ghada Mikhail, Augusto Pichard, Patrizia Presbitero, Alfredo E. Rodriguez**

*Operators:* **Bernard Chevalier, Philippe Garot, Thierry Lefevre**

*On-line factoids relevant to the cases presented:*

**Azeem Latib (Coordinator), Francesco Giannini, Neil Ruparelia**

12.30

***Closing remarks and JIM 2016 announcement***



### JIM 2015 Scientific Committee has selected the following posters:

- P1.** Myocardial salvage effect of remote concomitant and postconditioning using conventional blood pressure cuff in primary PCI for acute myocardial infarction  
Woo-Young Chung, Young-Seok Cho, Jae-Bin Seo, Hack-Loyung Kim, Hee-Jun Kim
- P2.** Left ventricular end diastolic pressure - a tool rediscovered to detect true myocardial ischemia during provocation test  
Ho-Jun Jang, Ji-Young Kim
- P3.** Sirolimus eluting - vs. Paclitaxel eluting-stent in patients with both renal insufficiency and ST-segment elevation acute myocardial infarction undergoing primary percutaneous coronary intervention  
Sang-Ho Jo, Woo-Jung Park, Hyun-Sook, Kim, Sang-Jin Han
- P4.** Osteoprotegerin gene polymorphism is not associated with angiographic coronary artery stenosis and calcification in korean  
Woo-Jung Park, Hyun-Sook Kim, Sang-Jin Han, Sang-Ho Jo
- P5.** Discriminative value of FKBI after 1-stent technique for treating true coronary bifurcation lesions with and without distal MV stenosis  
Tae-Hoon Kim, Sung Woo Kwon
- P6.** Feasibility and safety of the transradial approach for the intracoronary spasm provocation test: Results from the TRI Workgroup Registry  
Bong-Ki Lee, Seung-Woon Rha, Sang-Sig Cheong, Myung-Ho Jeong, In-Whan Seong, Dong-Ryul Ryu, Byung-Ryul Cho
- P7.** Four years' outcome of ad hoc versus elective percutaneous coronary intervention  
Behshad Naghshtabrizi, Shahram Homayoonfar, Azadeh Mozayanimonfared, Reza Kiani
- P8.** Usefulness of a long introducer sheath during right transradial interventions in patients with tortuous subclavian/aortic anatomy  
Roberto Neri, Fabio Ferranti, Piero Palermo, Roberto Mezzanotte, Fabrizio Ammirati
- P9.** Immediate and in-hospital complications of percutaneous coronary intervention  
Toufiqur Rahman, AAS Majumder, Afzalur Rahman, Mahboob Ali, Abdul Wadud Chowdhury

## Poster Session

**P10. Immediate and in-hospital outcome of percutaneous transvenous mitral commissurotomy in patients with mitral stenosis after previous surgical commissurotomy**  
Toufiqur Rahman, Syed Azizul Haque, AAS Majumder, Afzalur Rahman

**P11. Pulmonary balloon valvotomy as bailout in TOF**  
Vijayalakshmi IB, Natraj Setty H.S, Narasimhan C, Manjunath CN

**P12. Clinical and angiographic profile of Takayasu arteritis**  
Natraj Setty H.S, Muruli Rao, K.H. Srinivas, C.N. Manjunath

**P13. Complete versus incomplete revascularization: midterm and long-term clinical outcomes in revascularized patients presented with Acute Coronary Syndrome (ACS)**  
Omid Shafe, Madjid Chinikar, Abtin Heidarzadeh

**P14. Comparison of Carvedilol and  $\beta_1$ -Selective  $\beta$  Blockers in patients with acute myocardial infarction undergoing percutaneous coronary intervention**

Pil Sang Song, Guang-Won Seo, Dong-Kie Kim, Ki-Hun Kim, Sang-Hoon Seol, Han-Young Jin, Tae-Hyun Yang, Youngkeun Ahn, Myung Ho Jeong, Doo-Il Kim  
and other Korea Acute Myocardial Infarction Registry Investigators

**P15. Impact of the American College of Cardiology/American Heart Association Lesion Morphology Classification for outcome in patients with acute myocardial infarction**

Pil Sang Song, Guang-Won Seo, Dong-Kie Kim, Ki-Hun Kim, Sang-Hoon Seol, Han-Young Jin, Tae-Hyun Yang, Youngkeun Ahn, Myung Ho Jeong, Doo-Il Kim  
and other Korea Acute Myocardial Infarction Registry Investigators

**P16. Transcatheter closure of ventricular septal defects: a single center experience**

Milev I, Januska J, Zimbakov Z, Idrizi S, Ampova-Sokolov V, Zafirovska P, Angjuseva T, Mitrev Z

**Posters will be displayed in the Congress Area throughout the Meeting**

### Poster set up and removal

- Set up on Thursday, February 12th from 10.45 to 12.30
- Removal on Saturday, February 14th by 2:00 p.m.



# Scientific Information

## Language

English is the official language of the Congress.  
No simultaneous translation is available.



## Cases presentation and Posters

### Recorded procedures

Have a chance to show your best success or to discuss your worst complications in front of an outstanding panel in the Main Arena. Saturday morning will be devoted to cases review from Faculty and Attendance.

### Posters

Selected posters will be displayed in the Congress Area throughout the Meeting.

## Slide Center

A Slide Center will be available in the Congress Area. To allow a smooth running of sessions, Speakers are requested to contact this center and hand in their presentation at least **one hour before the beginning of their session** or the previous afternoon for the morning sessions.

TV direction and coordination by Mr. Sandro Alli  
Coordination of technical equipment by Mr. Paolo Torreggiani - LVS Solution  
Website by Extra.it Tecnomovie  
EDP Management by JOY Solutions Expert





# General Information

## Organizing Secretariat

Victory Project Congressi Via C. Poma, 2 - 20129 Milan - Italy  
Phone: +39 02.89.05.35.24 Fax: +39 02.20.13.95  
e-mail: info@victoryproject.it

## Secretariat on Site

Secretariat and Registration Desk at Congress Venue will be on duty from February 11 through 14.

### Opening hours

February 11	7.30 am - 6.00 pm for BRS Symposium 5.00 pm - 7.00 pm for JIM 2015
February 12	7.15 pm - 8.30 pm
February 13	7.30 am - 8.15 pm
February 14	7.00 am - 1.00 pm

## Coffee and refreshment

Coffee and refreshment will be organized in the Exhibition area.

## Lunch Buffet for Exhibitors

Buffet lunch will be served in Room Tintoretto subject to presentation of the daily ticket.

## Symposia for Physicians, Industry Professionals, Fellows and Nurses

Symposia will be organized in Room Michelangelo, Room Tiziano, Room Giotto. Participation is subject to presentation of the daily ticket (food and beverages included), **to be picked up at the INFO POINT DESKS located at each floor.**

## Technical exhibition

An exhibition of scientific and technical equipment will be organized in the Congress Area.

## Certificate of attendance

A certificate of attendance will be given to all registered participants upon presentation of their badge at the Secretariat Desk on Saturday, February 14, 2015.

# Registration

## Registration fees

Physicians	1.000,00 €
Special fare for GISE Member	700,00 €
Fellows, nurses, technicians	320,00 €
Industry Professionals (not having a stand)	1.000,00 €
Exhibitors (having a stand)	465,00 €

*(prices are in Euro and include VAT)*

Full registration fee for Physicians, Industry Professionals, Fellows, Nurses and Technicians includes:

- Admission to all Scientific Sessions
- Entrance to the Exhibition
- All Symposia (lunch included)
- Coffee and refreshment
- Congress kit

Registration fee for Exhibitors includes:

- Coffee and refreshment
- Entrance to the Exhibition
- Buffet lunch
- Congress kit

Only registered participants are allowed to attend scientific sessions. Participants are requested to wear their badge for all the Congress events.



# EBAC Accreditation

## EBAC Accreditation

The Joint Interventional Meeting JIM 2015 is accredited by the European Board for Accreditation in Cardiology (EBAC) for 19 hours of external CME credits.



Each participant should claim only those hours of credit that have actually been spent in the educational activity.

EBAC works according to the quality standards of the European Accreditation Council for Continuing Medical Education (EACCME), which is an institution of the European Union of Medical Specialists (UEMS).

In compliance with EBAC/EACCME guidelines, all speakers/chairpersons participating in this program have disclosed or indicated potential conflicts of interest which might cause a bias in the presentations. The Organizing Committee/Course Director is responsible for ensuring that all potential conflicts of interest relevant to the Programme are declared to the audience prior to the CME activities.





# Hotel Map

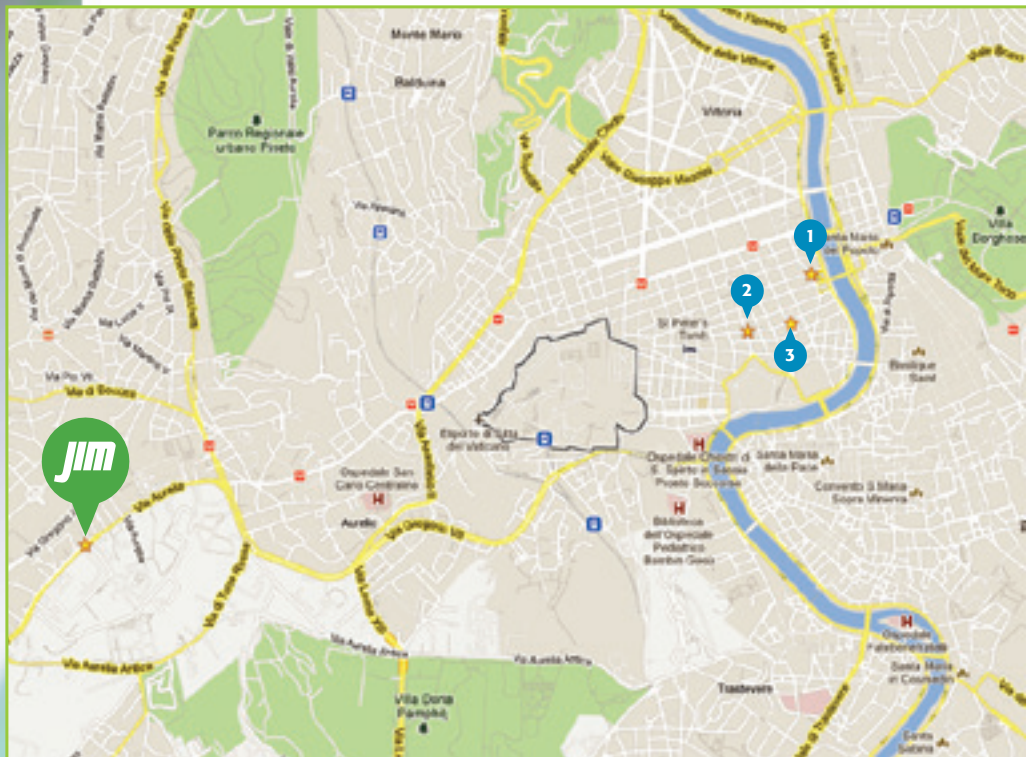

**JIM** **ERGIFE Palace Hotel** ☆☆☆

Via Aurelia, 619 - 00165 Roma

**1** **NH Hotel Leonardo da Vinci** ☆☆☆

Via dei Gracchi, 324 - 00192 Roma

**2** **NH Hotel Giustiniano** ☆☆☆

Via Virgilio, 1 - 00193 Roma

**3** **VOI Hotel Cicerone** ☆☆☆

Via Cicerone, 55/c - 00165 Roma

# Congress Area Map

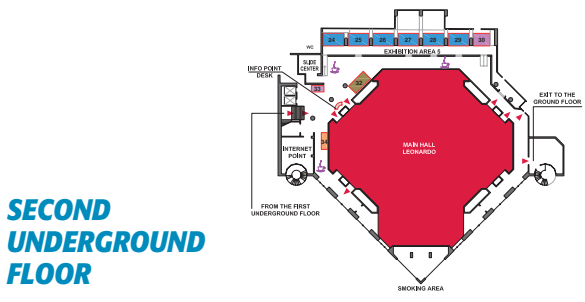
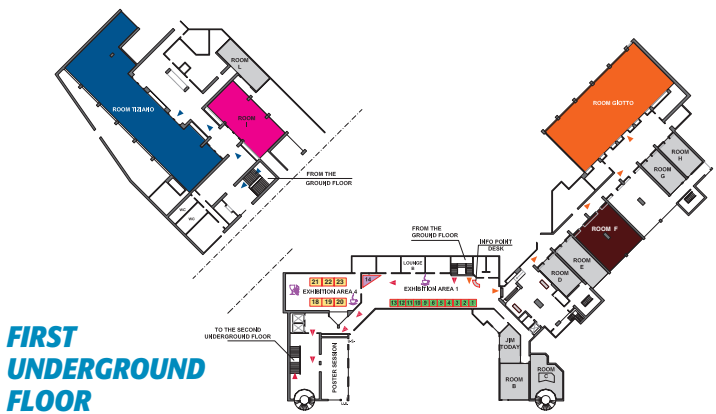
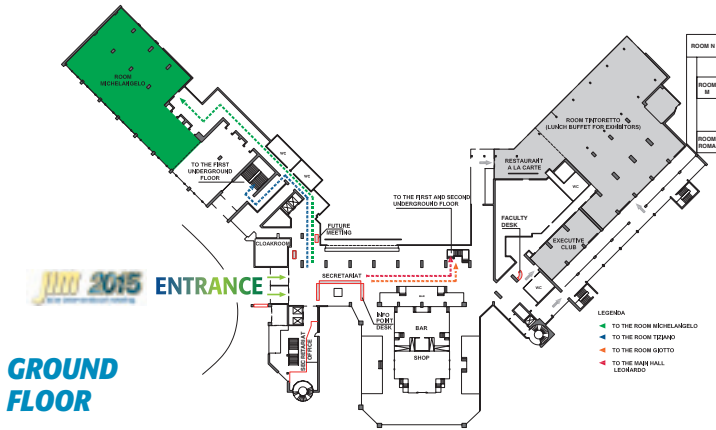

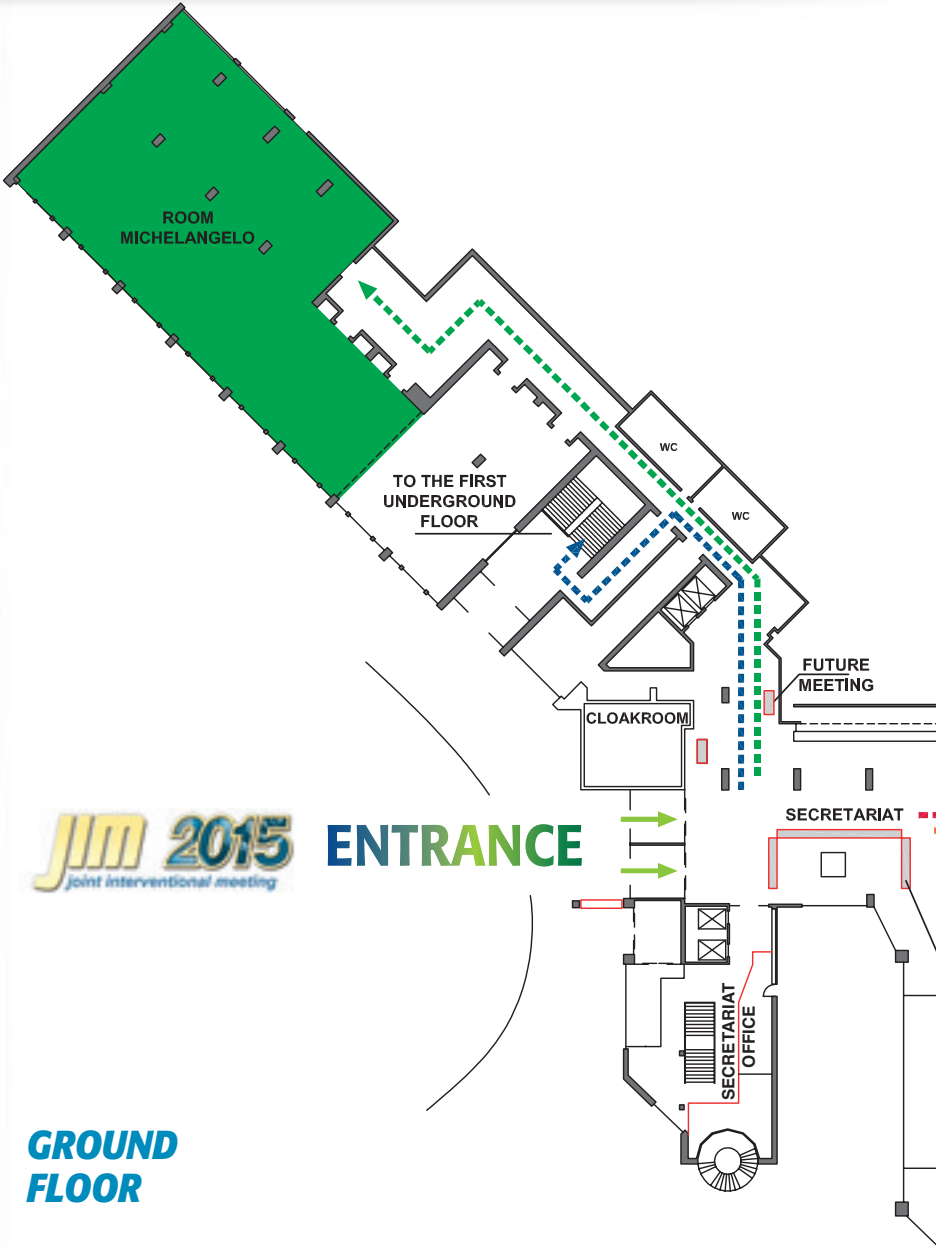

**JIM 2015**  
joint interventional meeting

**ENTRANCE**

**GROUND FLOOR**



# and Exhibition Map





## FIRST UNDERGROUND FLOOR

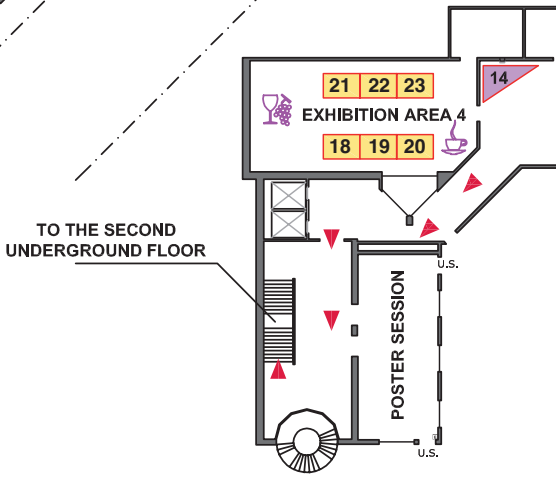

# and Exhibition Map



# Meeting Rooms and Exhibition Map

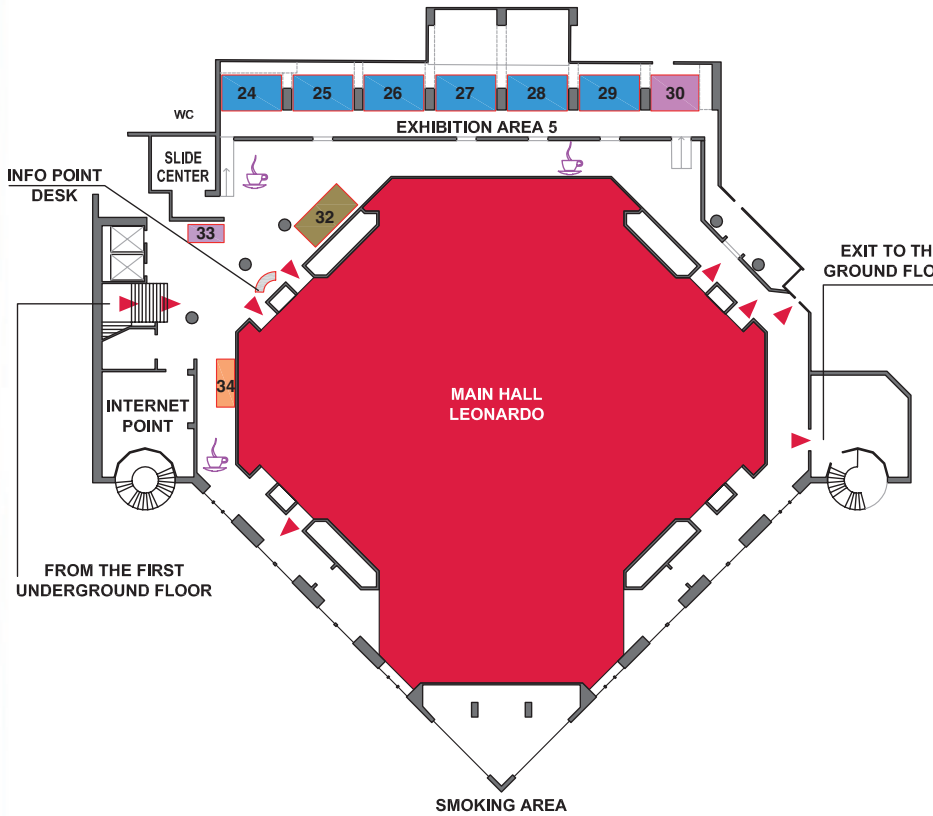

## SECOND UNDERGROUND FLOOR

## Exhibitors

Exhibitor	Stand
ABBOTT VASCULAR	1 & 2
ABIOMED EUROPE	33
ALVIMEDICA MEDICAL TECHNOLOGIES	28
BIOSENSORS INTERNATIONAL	14
BOSTON SCIENTIFIC	Lounge B
CARDIO ALEX 2015	21
CARDIOVASCULAR NEWS	20
CRF - Cardiovascular Research Foundation	22
CASCINA PASTORI - Wine Corner	
CLI FOUNDATION - ROME HEART RESEARCH	23
CORREVIO	9 & 10
EDWARDS LIFESCIENCES	32
ENDOTECH	25
ERCULES COMUNICAZIONI	18
FUTURE MEETINGS & PROMOTIONAL MATERIAL	Ground floor
INNOVA HTS	5 & 6

## **Exhibitors**

<b>Exhibitor</b>	<b>Stand</b>
<b>KARDIA</b>	11, 12 & 13
<b>MEDTRONIC</b>	26
<b>MINERVA MEDICA</b>	19
<b>OCCLUTECH ITALIA</b>	34
<b>ORBUSNEICH</b>	27
<b>ST. JUDE MEDICAL ITALIA</b>	3 & 4
<b>TERUMO EUROPE</b>	24
<b>WISEPRESS MEDICAL BOOKSHOP</b>	29 & 30





# Acknowledgments

## Thanks to:

4TECH CARDIO IRELAND

ABBOTT VASCULAR

AB MEDICA

ABIOMED EUROPE

ACIST MEDICAL SYSTEMS

ALVIMEDICA MEDICAL  
TECHNOLOGIES

AMARANTH MEDICAL

BIOSENSORS INTERNATIONAL

BOSTON SCIENTIFIC

CARDIAC DIMENSIONS

CORREVIO

DIRECT FLOW MEDICAL

EDWARDS LIFESCIENCES

ELIXIR MEDICAL CORPORATION

EDWARDS LIFESCIENCES

IFB STRODER

INNOVA HTS

INSPIRE MD

JOHNSON & JOHNSON MEDICAL  
Divisione Cordis

KARDIA

MEDTRONIC

MERIL LIFE SCIENCE

MITRALIGN

OCCLUTECH ITALIA

ORBUSNEICH

SHOCKWAVE MEDICAL

SPECTRANETICS INTERNATIONAL

STENTYS

ST. JUDE MEDICAL ITALIA

SYMETIS

TERUMO EUROPE

VALTECH CARDIO

VIOLATECH



fondazione  
**evidence**  
ONLUS

*(updated to January 30, 2015)*

## Major Sponsors

The Directors of the Course particularly wish to thank for their support in the organization of JIM 2015:



Boston  
Scientific



## Major Sponsors

They also express their gratitude to:





# JIM 2015

joint interventional meeting  
in partnership with 

**Leadership in Live Case Demonstration**

## Organizing Secretariat

VICTORY PROJECT CONGRESSI

Via C. Poma, 2 - 20129 Milano - Italy

Phone +39 02 89 05 35 24

Fax +39 02 20 13 95

e-mail [info@victoryproject.it](mailto:info@victoryproject.it)

**DON'T MISS**

# JIM 2016

joint interventional meeting

FEBRUARY 11 - 13, 2016